

INSTALLATION AND SPECIFICATION PAGE FOR FIRE ROCK FIRE RING

Site Preparation:

- Generally, a concrete pad 4 – 6 inches thick with footings as dictated by local building codes, is the best surface on which to erect any fire feature.
- With proper ground preparation, such as the gravel and sand layering under a paver patio, a Fire Rock Fire Ring may be installed without a concrete foundation.
- If it is your intention to install this product on a combustible surface (wooden deck), take extra precautions to insulate the surface under and surrounding the Fire Ring so that neither heat transference nor sparks present a hazard.

Center Base

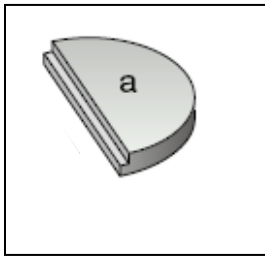

Riser Block

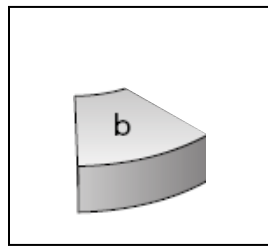

Fire Ring Block

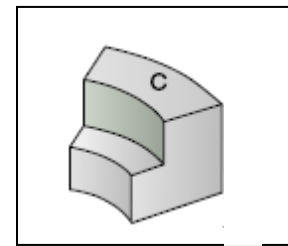

Specifications:

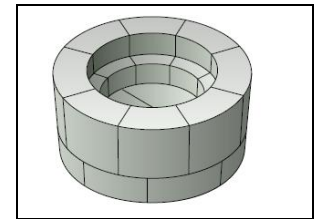
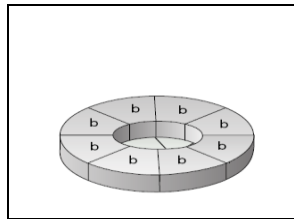
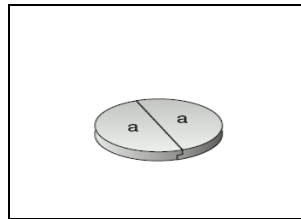
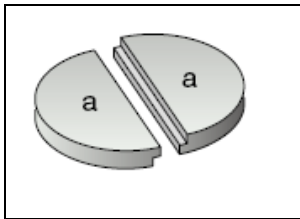
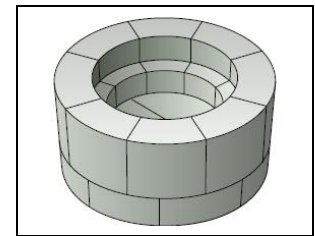
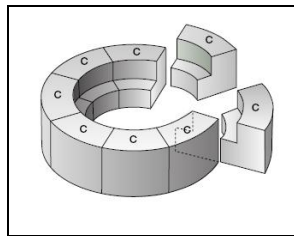
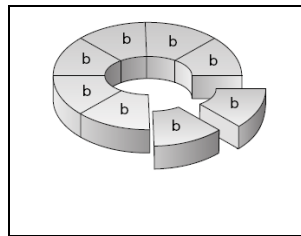
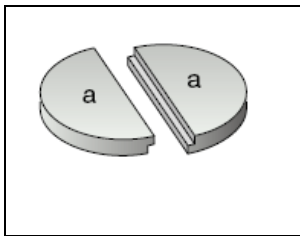
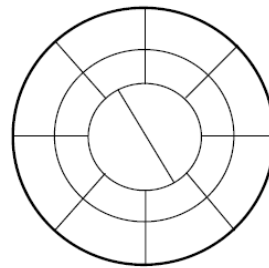
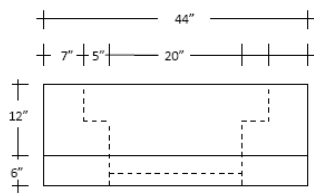

Step 1

Step 2

Step 3

Step 4

Each surface connecting with another surface must be generously covered with Fire Rock Adhesive Mortar.



Fire Rock Products, LLC
 Birmingham, AL
 (205) 639-5000
www.firerock.us

